

एक छलांग सुखाकारी भविष्य की और...



# JEET

*Residency*

3 BHK Luxurious Flat - Palaj,  
Nr.IIT Gandhinagar



## Specifications

### ■ STRUCTURE

Earthquake resistant, R.C.C. Frame Structure with brick masonry wall.

### ■ WALL FINISH

Internal single coat mala plaster with wall putty & external double coat sand faced plaster with acrylic paint.

### ■ FLOORING

Good quality Double Charge vitrified tiles in entire apartment. matt finish tiles in the wash area.

### ■ DOOR & WINDOW

Decorative main door & other door will be flush door in enamel paint. Pvc door in toilet.

Fully glazed powder coated Aluminum section sliding window with White Marble stone sill.

### ■ KITCHEN

Platform with granite, having S.S sink with designer Glazed tiles up to Above platform.

### ■ TOILET & PLUMBING

Glazed dado tiles up to lintel level & flooring concealed plumbing with C.PVC & U.PVC pipe, Good Quality sanitary ware & C.P Fitting.

### ■ ELECTRIFICATION

Single phase concealed copper wiring with good quality accessories with sufficient electric points. Geyser point in attached toilet. A.C point in master bedroom.

### ■ TERRACE

Open terrace to be finished with china mosaic for heat reflection & water proofing.



## 3 BHK FLAT

### Please Note :

Electricity charge, legal charges, GUDA charge, GST tax any other Government taxes and charges levied from time to time that shall be borne by the Purchaser. Stamp duty and registration fees shall be borne by the purchase on actual basis. Maintenance deposit shall be borne by the purchaser and other levies, taxes and duties in future by the statutory authorities the same shall be borne by the purchaser.

In the interest of continuous development in design and quality of construction, the developer reserves all rights to make any changes in the entire scheme or part of the scheme including specification, design, planning, layout and purchaser shall abide by such changes.

Purchaser are strictly not permitted to make any changes, alternations of any nature in the elevation, exterior colour scheme of the building or any changes affecting the overall design, concept and outlook of the entire scheme during or after completion of scheme.

This brochure is only to convey the essential design, display and technical feature of the scheme and does not treat as any part of the legal document. In case of the purchaser cancels the booking, he/she will get back the paid amount only when the registered unit get resale and after deduction of 10% of the total unit value.



# SHOPPING CENTRE Ground Floor

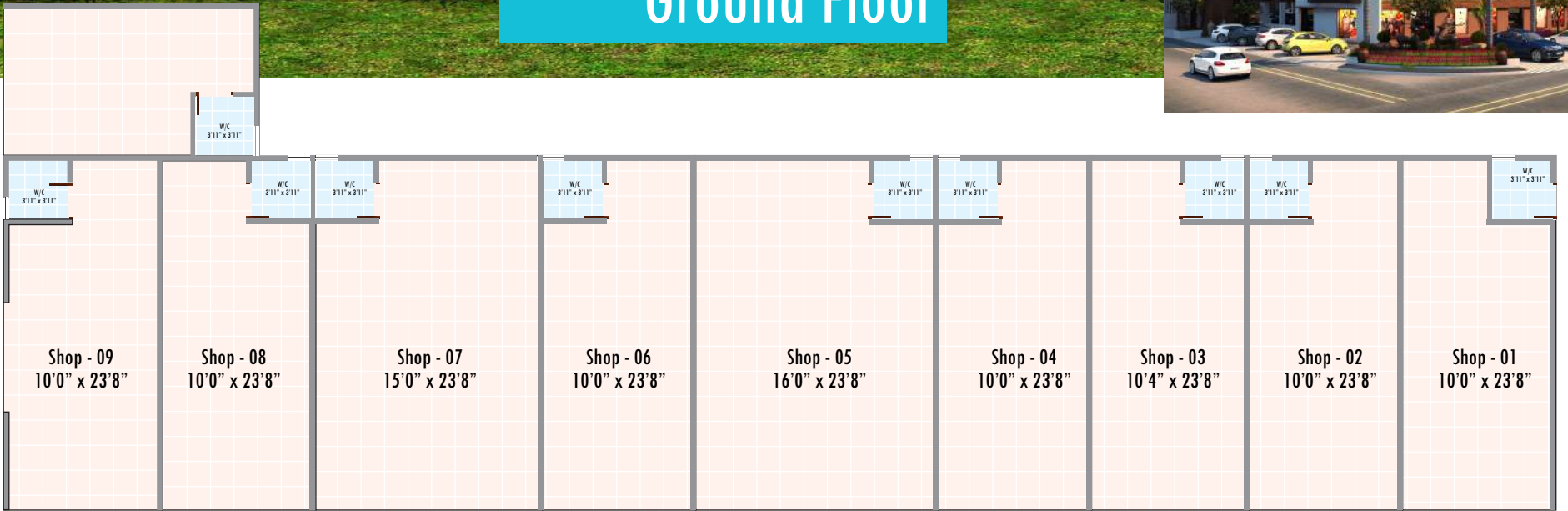



**3 BHK**  
Flat



# 3 BHK FLOOR PLAN

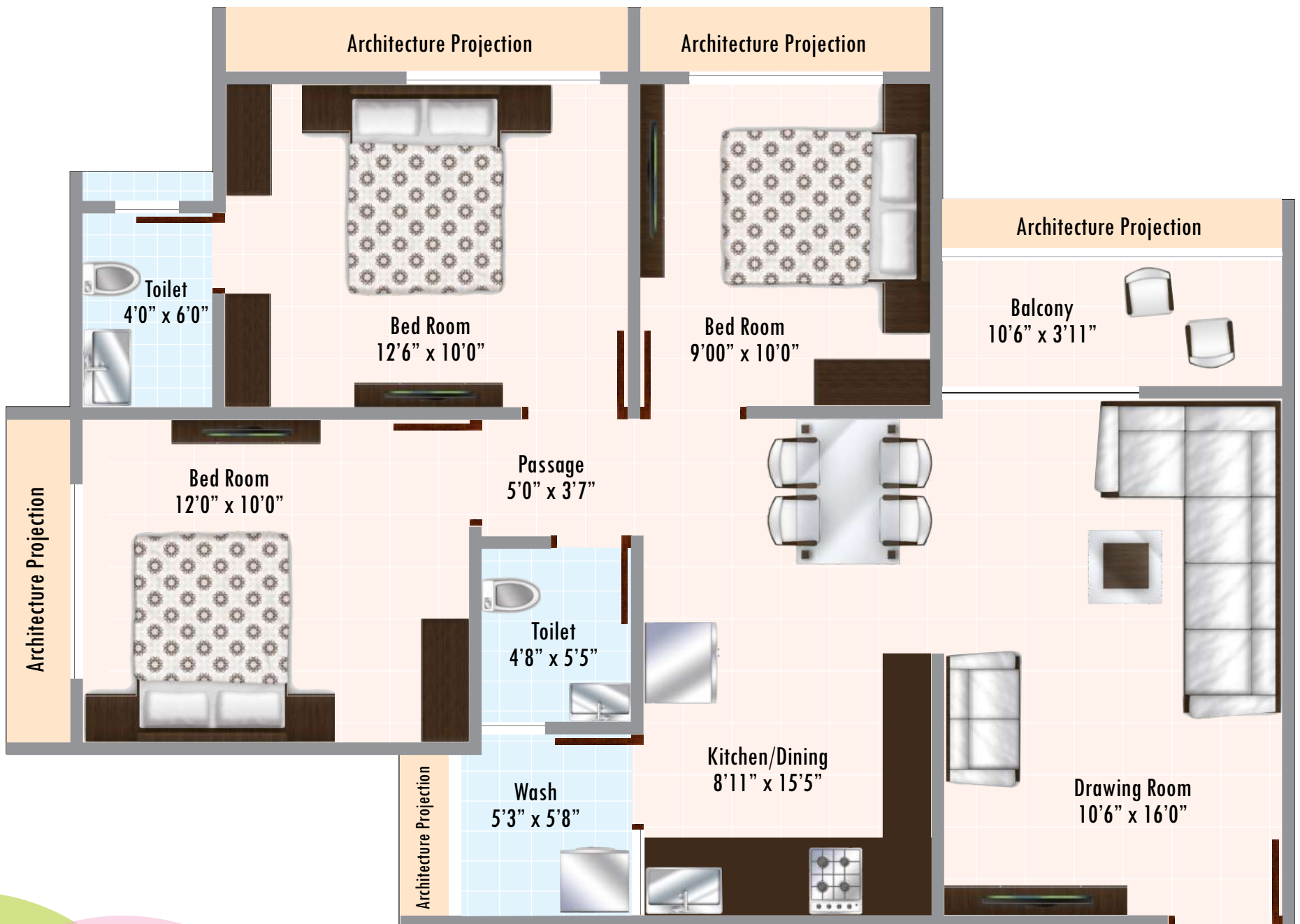

Welcome to your own nest where you can fly through the nature.  
We want you to look across your balcony and discover the shades of greens every time you wake up.  
We also want you to have the purest feeling while living....  
Looking forward to have you in the of nature.



**JEET** *Residency*

**3 BHK  
FLAT**





## Features

- Barrier free structure
- Sufficient Parking
- Large Landscape Garden
- R.C.C. Road with Street Light
- Ever Chirping Children Park
- Senior Citizen Area
- Bore Well for 24 Hours water supply
- One Lift Each Block with Power Back-up
- Well Design Entrance Foyer
- 24 hours Security
- Every Shop With Dedicated Toilet
- Gas Line
- CCVT



# KEY PLAN

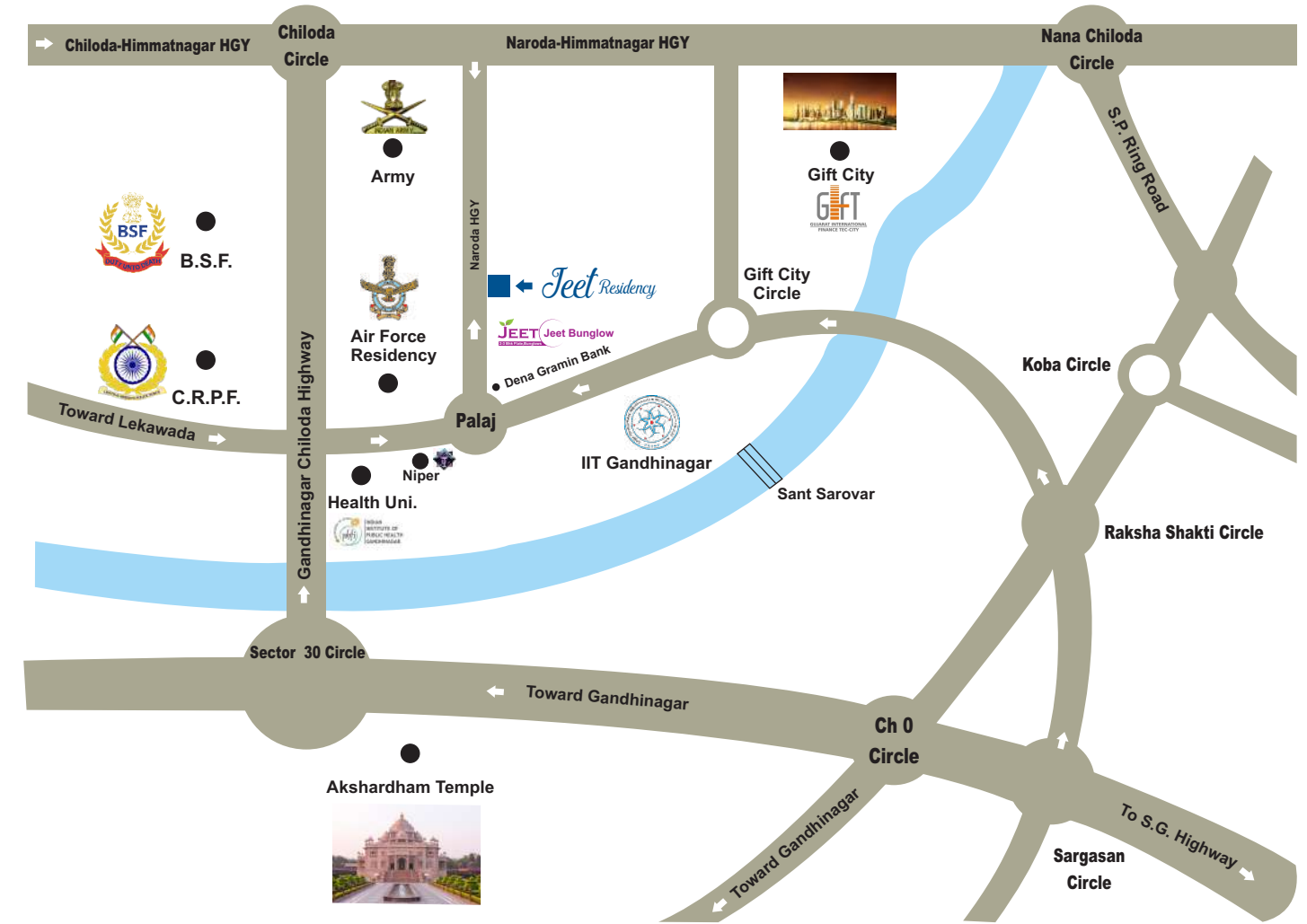

**JEET** Residency

### Location Advantage

IIT, Gandhinagar	1 k.m.
Air Force, SRPF, Army, BSF	3 k.m.
Akshar Dham Temple	4 k.m.
Gift City	5 k.m.
A'bad International Air Port	18 k.m.
Chiloda Circle	3 k.m.





# JEET *Residency*

**Site Address :**

Serve No.381,383/2,  
Nr. Jeet Bungalow,  
Opp.IIT Gandhinagar, Palaj

**E-mail :** [jitendra.bihola@yahoo.com](mailto:jitendra.bihola@yahoo.com)

**Contact Us :**

8511556444, 9924367101  
9558909090, 7043555553

**Design By :**



Rakesh Patel & Dilip Patel  
Gandhinagar

**Structural Design By :**



HNS DESIGN

